

Aaron Nimrod claim

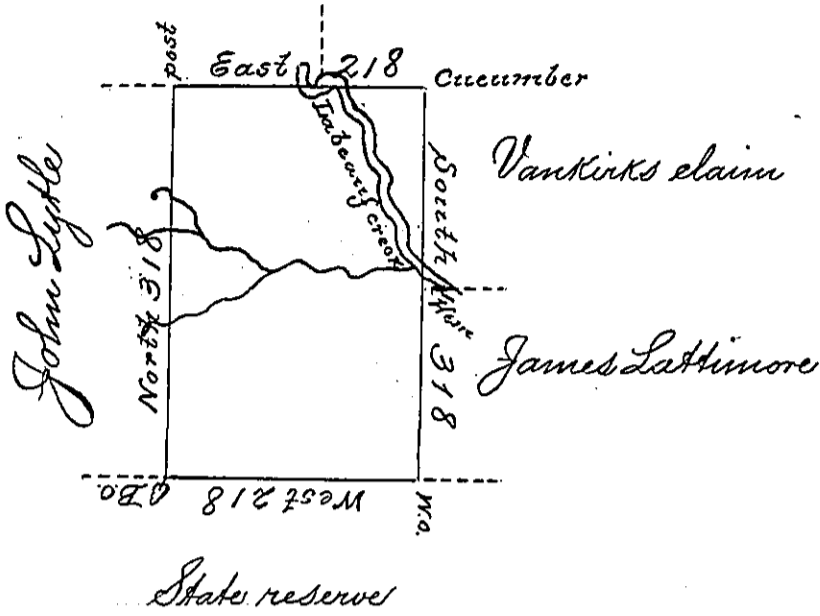

A Draught of a tract of Land in Waterford town-
 ship Erie County on Labeauf Creek. Surveyed the 12th
 of December 1801 for Aaron Nimrod by virtue of his Act-
 ual Settlement and improvement, and resurveyed the 13th
 of September 1802 in pursuance of a Warrant granted to the
 said Aaron Nimrod dated the 14th of April 1802, agreeable
 to the old lines. Containing 408 acres 112 perches allowance
 &c

To Samuel Cochran Esq^r }
 Surveyor General } John Cochran D^y

N.B. this tract was improved the 1st of September 1796. —

IN TESTIMONY that the above is a copy of the original remaining on file in
 the Department of Internal Affairs of Pennsylvania, made
 conformably to an Act of Assembly approved the 16th day of
 February, 1833, I have hereunto set my Hand and caused
 the Seal of said Department to be affixed at Harrisburg,
 this Second day of September 1902

James W. Latta
 Secretary of Internal Affairs.